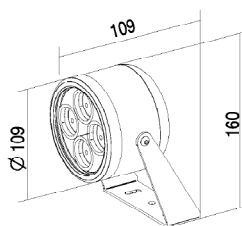

IP67 IK06 CE III WP TIPOLOGIA / *TYPOLOGY*Proiettore | *Projector*POSIZIONE INSTALLATIVA | *INSTALLATION POSITION***A terra, a parete, a soffitto o su pali/alberi***Ground, wall, ceiling or poles/trees mounting*AMBIENTE INSTALLATIVO | *INSTALLATION LOCATION***Esterno | *Outdoor***

FERE PROJECTOR L

**25W**

kg 1,55

## CARATTERISTICHE ELETTRICHE | ELECTRICAL FEATURES

POTENZA ASSORBITA   POWER CONSUMPTION	25W
ALIMENTAZIONE   POWER SUPPLY	24Vdc
ALIMENTATORE   POWER SUPPLY UNIT	25W - 24Vdc Non incluso   Not included
COLLEGAMENTO   CONNECTION	Parallelo   Parallel

## CARATTERISTICHE ILLUMINOTECNICHE | LIGHTING FEATURES

COLORE LED   LED COLOUR	2700K, 3000K, 4000K
INDICE RESA CROMATICA CRI   CRI	>80 (2700K, 3000K, 4000K)
BINNING	3 step MacAdam   3 MacAdam steps
OTTICHE   OPTICS	3° Sharp
FLUSSO REALE EMESSE - 3000K REAL OUTPUT FLUX	25W 422lm
DURATA MEDIA LED   AVERAGE LED LIFE	50.000h L80 B10

## CARATTERISTICHE MECCANICHE | MECHANICAL FEATURES

PESO   WEIGHT	Kg 1,55
FINITURE   FINISHES	Bianco txt, Grigio txt, Nero txt, Corten, Antracite txt, Sand Txt White, txt Grey, txt Black, Corten, txt Anthracite, Sand
INSTALLAZIONE   INSTALLATION	A terra, parete o soffitto con staffa (inclusa), a terra con picchetto (non incluso), su pali/alberi con cintura di fissaggio (non inclusa) Floor, wall or ceiling mounting with brackets (included), on ground with peg (not included), on poles/trees by mounting strap (not included)
MATERIALE   MATERIAL	Corpo in alluminio anticorrosivo, staffa in acciaio Inox AISI 316L, vetro trasparente Anticorrosive aluminium body, AISI 316L stainless steel bracket, transparent glass

## CARATTERISTICHE GENERALI | GENERAL FEATURES

TEMPERATURA DI ESERCIZIO OPERATING TEMPERATURE	-10°C +45°C
GRADO DI PROTEZIONE   INGRESS PROTECTION	IP67
GRADO DI RESISTENZA   IMPACT RESISTANCE	IK06
GLOW WIRE TEST   GLOW WIRE TEST	960°C
TEMPERATURA MASSIMA APPARECCHIO MAX. TEMPERATURE OF FIXTURE	40° @ Ta = 25°
CLASSE DI ISOLAMENTO   APPLIANCE CLASS	III
CALPESTABILE   WALKOVER	No
CARRABILE   DRIVE OVER	No
SICUREZZA STANDARD   STANDARD SAFETY	WP System
SICUREZZA FOTOBIOLOGICA PHOTOBIOLOGICAL SAFETY	GR1

NEW

## FERE PROJECTOR L 24Vdc

## ACCESSORI | ACCESSORIES

<b>CODICE / CODE</b>	<b>PL005</b>
<b>TIPOLOGIA / TYPOLOGY</b>	<b>Paralume</b> Shade  kg 0,19
<b>MATERIALE / MATERIAL</b>	<b>Alluminio</b> Alluminium

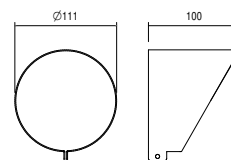

<b>CODICE / CODE</b>	<b>PI002</b>
<b>TIPOLOGIA / TYPOLOGY</b>	<b>Picchetto</b> Peg  kg 0,10
<b>MATERIALE / MATERIAL</b>	<b>Acciaio inox</b> Stainless steel



<b>CODICE / CODE</b>	<b>CIN20</b>
<b>TIPOLOGIA / TYPOLOGY</b>	<b>Cinghia di fissaggio</b> Mounting Strap  kg 0,11
<b>MATERIALE / MATERIAL</b>	<b>Nastro in poliestere, fibbia e basetta in acciaio inox</b> Polyester tape, stainless steel buckle and base

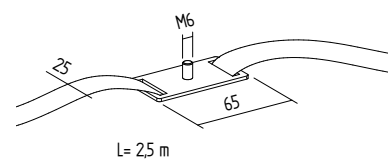

<b>CODICE / CODE</b>	<b>ST023</b>
<b>TIPOLOGIA / TYPOLOGY</b>	<b>Staffa</b> Bracket  kg 0,21
<b>MATERIALE / MATERIAL</b>	<b>Acciaio inox</b> Stainless steel

